

DC Axial Fan Ball Bearing



■ General Specifications

- Motor Protection : Auto Restart
- Insulation Resistance : 10MΩ or over with a DC500V Megger
- Dielectric Withstand Voltage : AC700V 1s
- Allowable Ambient : (-40°C~+105°C) (Operating)
- Temperature Range : (-40°C~+105°C) (Storage)
- non-condensing environment

■ Outline

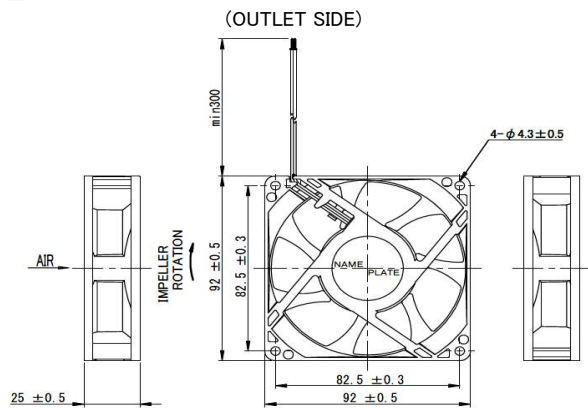

■ Material

- Casing : Plastic
- Impeller : Plastic
- Bearing : Ball Bearing
- Lead Wire : +:Red, -:Black
- [Option] Speed Signal (2pulse/rev) :White (open drain)
- PWM Speed Control : Brown

■ Characteristic Curves

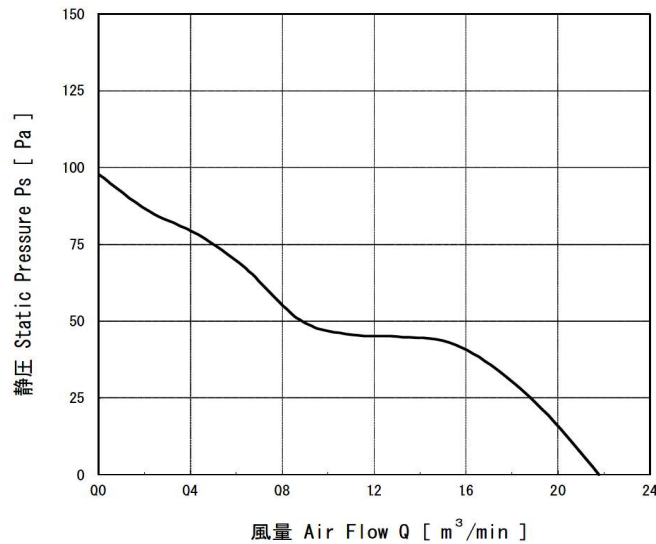

■ Typical characteristics of the soft-tool sample

Model	Rating Voltage	Operating Voltage	Current	Input Power	Speed	Max. Volume Flow rate	Max. Static Pressure		Acoustic Noise	
	(V)	(V)	(A) ^{*1}	(W) ^{*1}	(min ⁻¹) ^{*1}	(m ³ /min) ^{*1}	(CFM) ^{*1}	(Pa) ^{*1}	(In H ₂ O) [*]	(dB) ^{*1,*2}
09225UA12N	12	9 ~ 16	0.40	4.80	4500	(2.18)	(77.0)	(98.0)	(0.39)	Typ 45

Rotation : Clockwise as seen from the label side

Airflow Outlet : Label side

*1: Average Values in Free Air. It is the reference value of the soft-tool sample, not guaranteed value.

*2: Measured by Microphone distance 1m.